

Specifications

Model		NP-PX1004UL-WH / NP-PX1004UL-BK	NP-PX803UL-WH / NP-PX803UL-BK
Method		Reflection by single DMD chip	
Specifications of main parts			
Main panel	Size	0.67" 2 × LVDS (aspect ratio: 16:10)	
	Pixels* <sup>1</sup>	2,304,000 (1,920 dots × 1,200 lines)	
Projection lenses	Zoom		
	Focus		
	Lens shifting	Power-adjustable	
Light source		Blue laser diode	
Light source (laser diode) life* <sup>2</sup>		20,000 hours	
Optical unit		C / W type (DLP), colour separation by colour wheel; time-multiplexing colour wheel method	
Light output * <sup>3,4</sup>	Normal mode	10,000 ANSI lumens	8,000 ANSI lumens
	ECO1/ ECO2	Approx. 80% / Approx. 50%	
Contrast ratio* <sup>4</sup> (all white / all black)		10,000:1 with dynamic contrast	
Screen size		50" to 300", 100" to 350" (NP39ML)	
Colour reproducibility		10-bit colour processing (approx. 1.07 billion colours)	
Quietness (ECO2 / ECO1 / Normal mode)		37 dB / 39 dB / 42 dB	35 dB / 37 dB / 40 dB
Scan rate	Horizontal	Analog: 15 kHz, 24 to 100 kHz (24 kHz or greater for RGB inputs) / Digital: 15 kHz, 24 to 153 kHz	
	Vertical	Analog: 48 Hz, 50 to 85 Hz, 100 Hz, 120 Hz / Digital: 24 Hz, 25 Hz, 30 Hz, 48 Hz, 50 to 85 Hz, 100 Hz, 120 Hz	
Max. display resolution (horizontal × vertical)		Analog: 1,920 × 1,200 (with Advanced AccuBlend) / Digital: 4,096 × 2,160 (with Advanced AccuBlend)	
Input / output connectors			
Computer / component	Video input	Mini D-Sub 15-pin × 1, 5BNC × 1	
HDMI®	Video input	Type A 19-pin HDMI® connector with HDCP (V1.4) × 1	
input terminals	Audio input	Yes	
HDMI®	Video output	Type A 19-pin HDMI® connector with HDCP (V1.4) × 1	
output terminal	Audio output	Yes	
HDBaseT™	Video input	RJ45 × 1 (IEEE 802.3 / 802.3u 10BASE-T / 100BASE-TX), shared with Ethernet	
	Audio input	Yes	
DisplayPort™	Video input	DisplayPort 20-pin connector × 1	
	Audio input	Yes	
BNC (CV)	Video input	BNC × 1	
BNC (Y/C)	Video input	BNC × 2	
PC control connector		D-Sub 9-pin × 1	
USB port		USB type A × 1	
Ethernet port		RJ-45 × 1, (supports 100BASE-TX), shared with HDBaseT	
Remote connector		Stereo mini jack × 1	
3D SYNC output terminal		5 V / 10 mA, synchronized signal output for 3D use	
Option slot		OPS type × 1	
Usage environment* <sup>5</sup>		Operating temperature: 5 to 40°C* <sup>6</sup> , operating humidity: 0 to 80% (with no condensation) Storage temperature: -10 to 60°C, storage humidity: 0 to 90% (with no condensation) Operating altitude: 0 to 3,000 m	
Power supply		110 – 240 V AC, 50 / 60 Hz	100 – 240 V AC, 50 / 60 Hz
Power consumption	Normal	1,220 W (110 – 130 V) / 1,165 W (200 – 240 V)	874 W (100 – 130 V) / 850 W (200 – 240 V)
	ECO1	980 W (110 – 130 V) / 930 W (200 – 240 V)	695 W (100 – 130 V) / 680 W (200 – 240 V)
	ECO2	625 W (110 – 130 V) / 605 W (200 – 240 V)	456 W (100 – 130 V) / 446 W (200 – 240 V)
	STANDBY (NORMAL)	Less than 0.3 W	Less than 0.27 W
	STANDBY (NETWORK)	Less than 4.5 W	Less than 4.4 W
Rated input current		11.6 – 5.2 A	9.4 – 3.8 A
Cabinet colour		White : -WH, Black : -BK	
Dimensions (W × H × D)		500 × 216 × 583 mm (not including lens) 500 × 211 × 577 mm (not including protruding parts)	
Weight		29.0 kg (not including lens)	28.0 kg (not including lens)

\*1: Effective pixels are more than 99.99%.  
\*2: Time at which the laser light source is at half brightness; not a guarantee time.  
\*3: This is the light output value that results from setting the [LIGHT MODE] to [NORMAL] and setting the [PRESET] to [HIGH-BRIGHT] while using the NP18ZL lens (sold separately).  
\*4: Compliant with ISO21118-2012.  
\*5: Depending on the altitude and temperature, the projector goes into "Forced ECO MODE".  
\*6: 10 to 40°C while using the NP39ML

These specifications and the product's design are subject to change without notice.

Throw distance and screen size

Screen size (W × H)	Lens model name								
	NP39ML	NP16FL	NP31ZL	NP17ZL	NP18ZL	NP19ZL	NP20ZL	NP21ZL	
50" (1.08 × 0.64)	–	0.8	0.8-1.0	1.3-1.9	1.8-2.4	2.4-4.0	3.8-5.8	5.6-8.9	
60" (1.29 × 0.81)	–	1.0	1.0-1.2	1.6-2.3	2.2-2.9	2.8-4.8	4.6-7.0	6.8-10.7	
80" (1.72 × 1.08)	–	1.3	1.3-1.6	2.2-3.1	3.0-3.9	3.8-6.4	6.2-9.3	9.1-14.4	
100" (2.15 × 1.35)	0.8	1.7	1.6-2.0	2.7-3.9	3.7-4.9	4.8-8.0	7.7-11.7	11.5-18.1	
120" (2.59 × 1.62)	1.0	2.0	2.0-2.5	3.3-4.7	4.5-5.9	5.8-9.6	9.3-14.1	13.8-21.7	
150" (3.23 × 2.02)	1.2	2.5	2.5-3.1	4.1-5.8	5.6-7.4	7.2-12.0	11.7-17.6	17.4-27.3	
200" (4.31 × 2.69)	1.6	3.4	3.3-4.1	5.5-7.8	7.5-9.9	9.7-16.1	15.6-23.5	23.3-36.4	
240" (5.17 × 3.23)	1.9	4.1	4.0-5.0	6.6-9.4	9.1-11.9	11.6-19.3	18.8-28.3	28.0-43.8	
300" (6.46 × 4.04)	2.3	5.1	5.0-6.2	8.2-11.7	11.3-14.9	14.5-24.1	23.5-35.4	35.0-54.8	

\*Stated projection distances are standard values from lens or mirror surface to screen centre.  
\*For a stack installation, the recommended projection distances will be different.  
\*The values in the table are design values and may vary.



- Do not stare into the lens while in use.
- The laser module is equipped in this product.
- The PX803UL is classified as Class 1 of IEC60825-1 Third edition 2014-05, Class 3R of IEC60825-1 Second edition 2007-03 and RG2 of IEC62471-1 : 2006.
- The PX1004UL is categorized in the risk group 2 of IEC62471-5: 2015.
- The projector can be unplugged during its cool down period after it is turned off.
- Parts of the projector become heated during operation.
- Use caution when picking up the projector immediately after it has been operating.

PX1004UL / PX803UL

Remote control

(included accessory)



Options

Lenses

- NP39ML (Throw Ratio 0.38)
- NP16FL (Throw Ratio 0.76)
- NP31ZL (Throw Ratio 0.75-0.93)
- NP17ZL (Throw Ratio 1.25-1.79)
- NP18ZL (Throw Ratio 1.73-2.27)
- NP19ZL (Throw Ratio 2.22-3.67)
- NP20ZL (Throw Ratio 3.58-5.38)
- NP21ZL (Throw Ratio 5.31-8.26)

Slot boards

SDI

SB-04HC (3G/HD/SD-SDI)



OPS single board controller (computer)  
N8000-8866 (Core i5 60GB-SSD)  
N8000-8865 (Core i5 320GB-HDD)



Cabinet dimensions

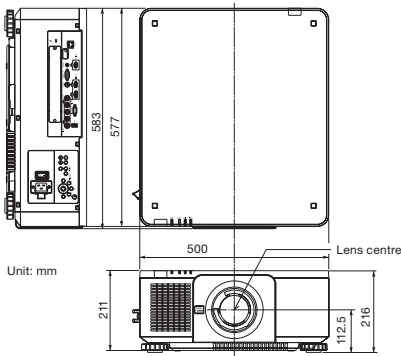

Unit: mm

Installation Projector

Orchestrating a brighter world

NEC

Powerful installation projector with a laser-phosphor light source

PX1004UL / PX803UL



4HDBT™  
ASE1

HDMI®  
HIGH-DEFINITION MULTIMEDIA INTERFACE

D™



# The NEC PX1004UL and PX803UL offer all the benefits of the most up to date laser light source and professional installation features.

## Advanced Installation Capabilities

### No More Lamp Replacements

Up to 20,000 hours\* of maintenance-free operation is possible due to the laser light source.

\* Actual hours may vary depending on usage conditions.

### Tilt-free and Portrait Installation Support

The projector can be rotated freely (360°) to point up or down depending on the installation requirements and can be rotated (along with the screen if necessary) to a vertical alignment so that portrait content can be viewed without black bars on the sides when landscape mode is used.

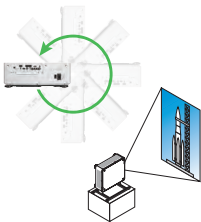

### Geometric Correction

Projection is not confined to a standard flat screen or wall. Geometric correction allows this model to project an image on spheres, cylinders, corner angles and many more non-standard surfaces.



### Stacking Correction

This feature allows the projectors to boost an image's brightness up to 40,000 ANSI lm, which is ideal for larger-sized screens and environments with heavy ambient light. This feature also prevents the complete loss of an image, which can happen when using only one projector.

### Easy Installation

A selection of wide zoom bayonet lenses, wide vertical and horizontal lens shift and control code emulation guarantee hassle-free installation and replacement of existing installation projectors.

### Dustproof Design Supported by Closed-loop Cooling

The projector has a dustproof design to prevent the staining of optical components from the ingress of dust and the deterioration of brightness and image quality.

### Built-in Edge Blending

This function seamlessly blends multiple projected images to display a single high-resolution image.



### Multiscreen Function

Multi-display capabilities and tiling technologies are integrated. The projector is also equipped with multiple digital input and HDMI output terminals that can connect multiple projectors in a digital daisy chain. These cutting-edge functions produce a beautiful high-resolution image, including a 4K/2K high-resolution display using 4 projectors and various picture in picture / picture by picture configurations.

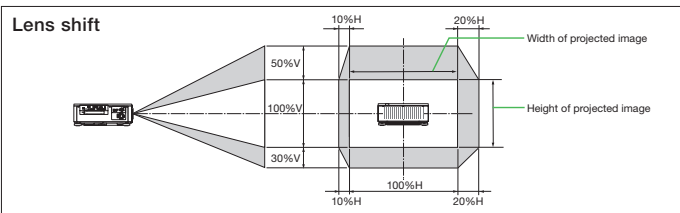
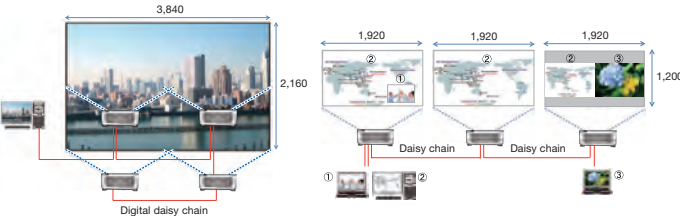

	NP39ML	NP16FL	NP31ZL	NP17ZL	NP18ZL	NP19ZL	NP20ZL	NP21ZL
Option lens								
Lens type	Fixed ultra-short mirror lens	Fixed short throw lens	Zoom lens					
Zoom/Focus	Powered focus		Powered zoom and focus					
Zoom ratio	-		1.25	1.41	1.31	1.65	1.5	1.55
Throw Ratio	0.38 : 1	0.76 : 1	0.75 - 0.93 : 1	1.25 - 1.79 : 1	1.73 - 2.27 : 1	2.22 - 3.67 : 1	3.58 - 5.38 : 1	5.31 - 8.26 : 1
F	2.0	1.85	1.96 - 2.30	1.85 - 2.50	1.64 - 1.86	1.86 - 2.48	1.85 - 2.40	1.85 - 2.48
f (mm)	5.64	11.6	11.3 - 14.1	18.7 - 26.5	25.7 - 33.7	32.91 - 54.23	52.8 - 79.1	78.5 - 121.9
Screen size	100 - 350 inches		50 - 300 inches					
Light output *1	PX1004UL	7,700 ANSI lm	9,300 ANSI lm	8,700 ANSI lm	9,100 ANSI lm	10,000 ANSI lm	9,200 ANSI lm	8,700 ANSI lm
	PX803UL	6,200 ANSI lm	7,500 ANSI lm	7,000 ANSI lm	7,300 ANSI lm	8,000 ANSI lm	7,400 ANSI lm	7,000 ANSI lm
Lens Shift	Vertical	-	0	+0.5V / -0.3H				
	Horizontal	-	0	0.1H and other side 0.2H (refer to the image)				
Weight	2.7 kg	0.9 kg	1.3 kg	1.1 kg	0.8 kg	1.0 kg	1.0 kg	1.35 kg

\*1: [PRESET] mode is [HIGH-BRIGHT]

## Fantastic Cinema Quality Picture

### Equipped with NEC's NV1301 4,096 × 2,160 Scaler Chip and the 3rd-generation Sweetvision™ Circuit

This 10-bit video processor represents an enormous leap in video processing, with true flagship performance in noise reduction, de-interlacing and scaling.



- 4K Ultra HD support (4,096 × 2,160 / 3,840 × 2,160)
- 12-bit gamma correction
- Advanced colour correction (6-axis saturation and hue adjustment / skin tone)
- Video and film cadence detection (multi cadence)
- Per-pixel motion adaptive de-interlacing
- Detail enhancement
- Super resolution correction (3rd-generation Sweetvision™)
- 3D random, mosquito and block noise reduction

## Compatible with Diverse Signal Sources

### Built-in HDBaseT Support

Simplify your installations with HDBaseT, which is optimized for video applications and supports uncompressed Full HD digital video, audio, Ethernet, and various control signals. With only a single cable (up to 100 m) to run, infrastructure and labour costs are reduced, installations are significantly easier, and there is no cable clutter to manage. With uncompressed HD video support, images have never been more stunning. What is more, control signals are contained in the same cable.



### Wide Selection of Inputs and Outputs Such as HDMI and DisplayPort

The projector is equipped with a wide range of input / output terminals and compatible with a variety of image sources, which lets you connect HDMI, DisplayPort, computer (analog), 5-core BNC, and video sources.



### Expansion Slot

The slot technology allows for the integration of Open Pluggable Specification (OPS\*) boards and other option slot products without the need to store additional external equipment. This offers the greater flexibility customers require.

\*OPS is a standard established by Intel Corporation.

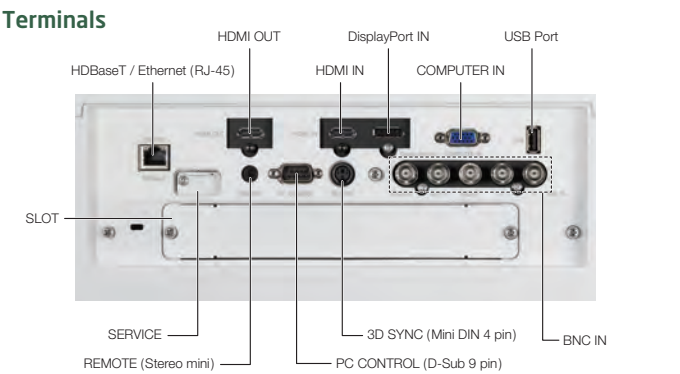

## Other Useful Functions and Features

- Lens shutter
- Program timer with real time clock / off timer
- Remote control ID
- Direct power on/off, auto power on/off
- PIN security / control panel lock / security bar / security slot

### Network Control

NaViSet Administrator 2 / PC control / alert mail  
CRESTRON ROOMVIEW™ / AMX BEACON  
PJLink / HTTP server (projector adjustment)



PX1004UL

10,000 ANSI lumensWUXGA29.0 kg

Brightness using PX1004UL with NP18ZL.  
Weight does not include lens.

PX803UL

8,000 ANSI lumensWUXGA28.0 kg

Brightness using PX803UL with NP18ZL.  
Weight does not include lens.

